



Town of Long Island Parking Committee Spring 2023 Recommendations



Context

After the previous Parking Committee submitted their recommendations to the Select Board in 2018, the Mariner's Wharf parking lot was re-striped and parking limits were changed to increase efficiency.

This Parking Committee was formed in 2023 after concern was voiced regarding parking at **Mariner's Wharf**, **'Down Front'**, and at **South Beach**.

This Committee was tasked with reviewing and considering Long Island's current parking concerns and to make recommendations based on our findings.

By the Numbers

Mariner's Wharf Parking

Long Island has more municipal ferry parking spaces than any other unbridged island in Maine.

Total Vehicle Parking Spaces at Island Ferry

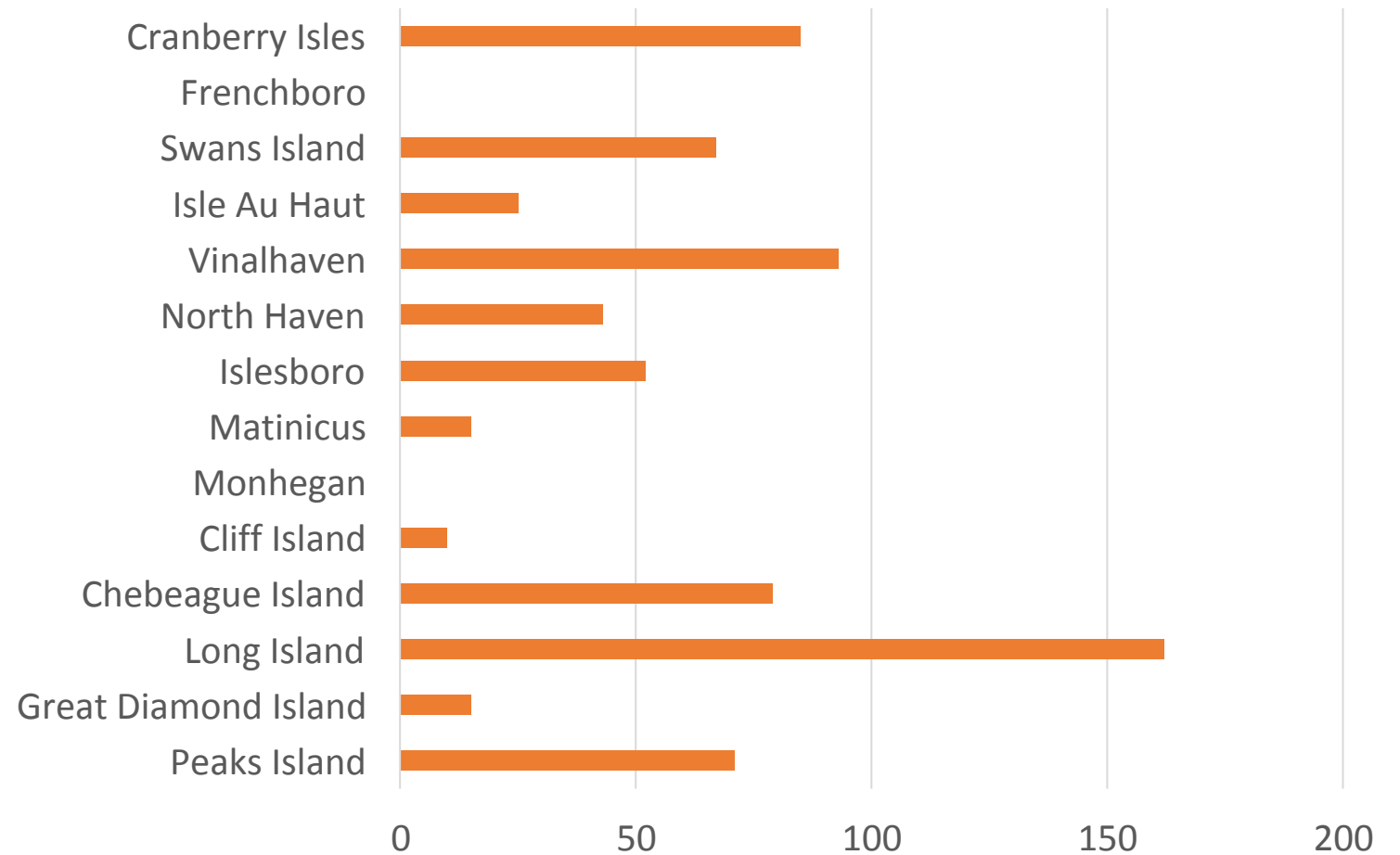

By the Numbers

Mariner's Wharf Parking

Even when peak season populations estimates are considered, Long Island still boasts the most municipal parking spaces per capita.

Ferry Parking Spaces Per Capita During Peak Summer Population

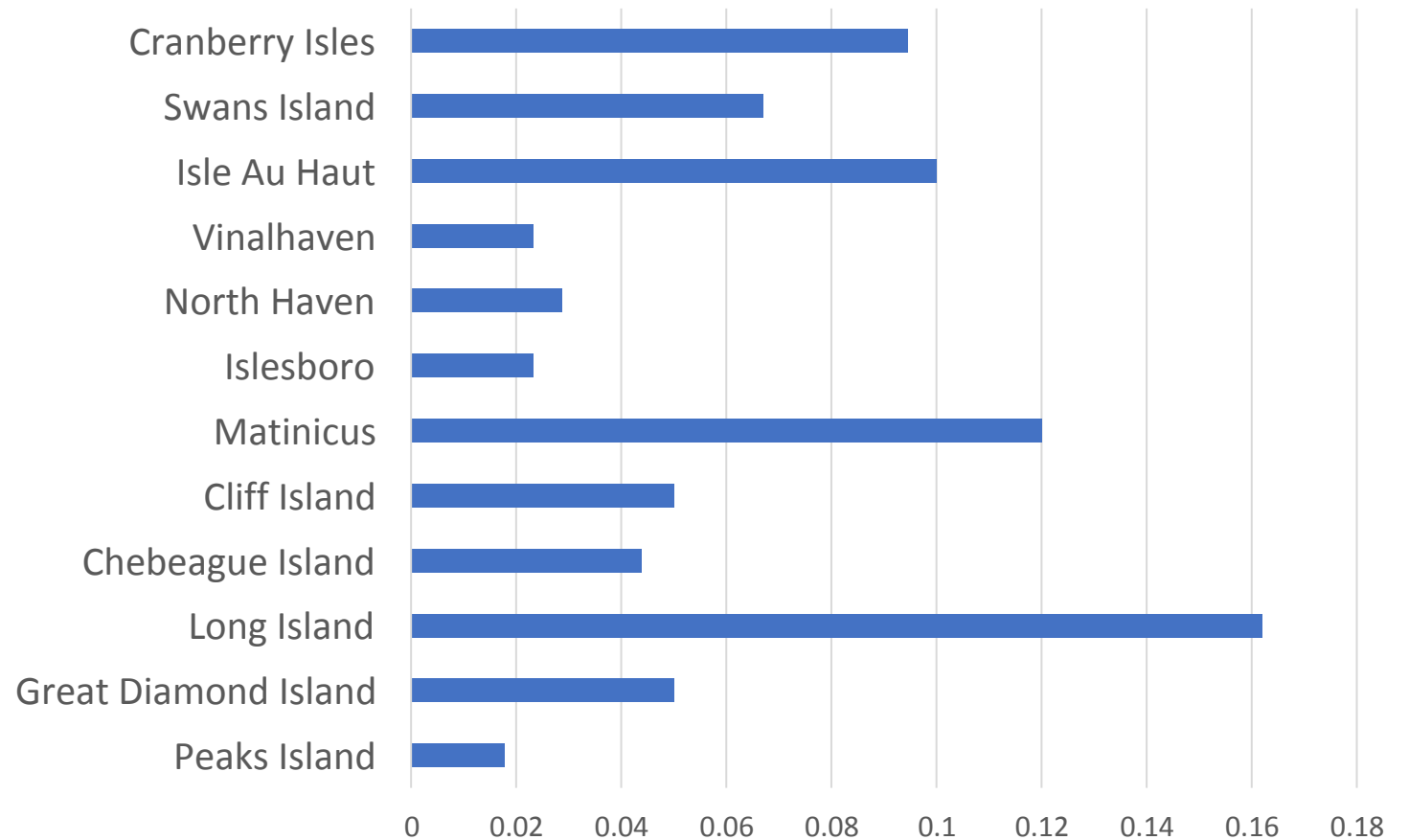

envision
LONG ISLAND • ME
2035 
COMPREHENSIVE PLAN

Since 2007, Long Island has seen a 70% increase in total vehicles on the island.

The addition of 163 Golf Carts since 2007 has changed the need of the Mariner’s Wharf parking lot to include efficient spaces for Golf Carts and ATVs.

Vehicles on Long Island 2007-2021

YEAR	TOTAL	VEHICLES*	GOLF CARTS	ATVs
2021	682	468	214	**
2020	513	322	178	13
2019	522	341	169	12
2018	501	323	168	10
2017	481	321	149	11
2016	437	284	143	10
2015	429	288	130	11
2014	413	284	121	8
2013	408	287	118	3
2012	378	280	95	3
2011	369	275	88	6
2010	368	281	82	5
2009	375	298	77	8
2008	378	316	62	2
2007	401	350	51	1
	Overall	Vehicles*	Golf Carts	ATV
	+70%	+34%	+20%	+1200%

* Cars, vans, trucks, ATVs, trailers

** ATV count for 2021 not available

Source: LICP compilation of Long Island town data

Remember

In 2007 (as this photo shows), prior to the sharp increase in vehicles on Long Island, the parking lot reached capacity just as it does on occasion today.



2007

Where we can improve

Mariner's Wharf Parking

Just because we have the most parking of any island and have historically reached capacity in the parking lot does not bar us from making positive changes to offer a better parking experience and to maximize our current parking lot size.

The Long Island Comprehensive Plan passed unanimously at last year's Town Meeting recommends: **“Continue to encourage on-island vehicle owners to store vehicles on private property for longer parking needs. Enforce current parking restrictions and consider reducing parking duration limits if needed.”** (p. 178)

- Simplify Parking Term Limits
- Improve enforcement
- Add spaces where appropriate and fix current signage errors

Simplify Parking

Mariner's Wharf

Mariner's Wharf

Daily - 45 Spots
72 Hours - 33 Spots
Weekly - 19 Spots
Golf Cart - 28 Spots
Handicap Cars - 6 Spots
Handicap Carts - 3 Spots

Current Parking Lot

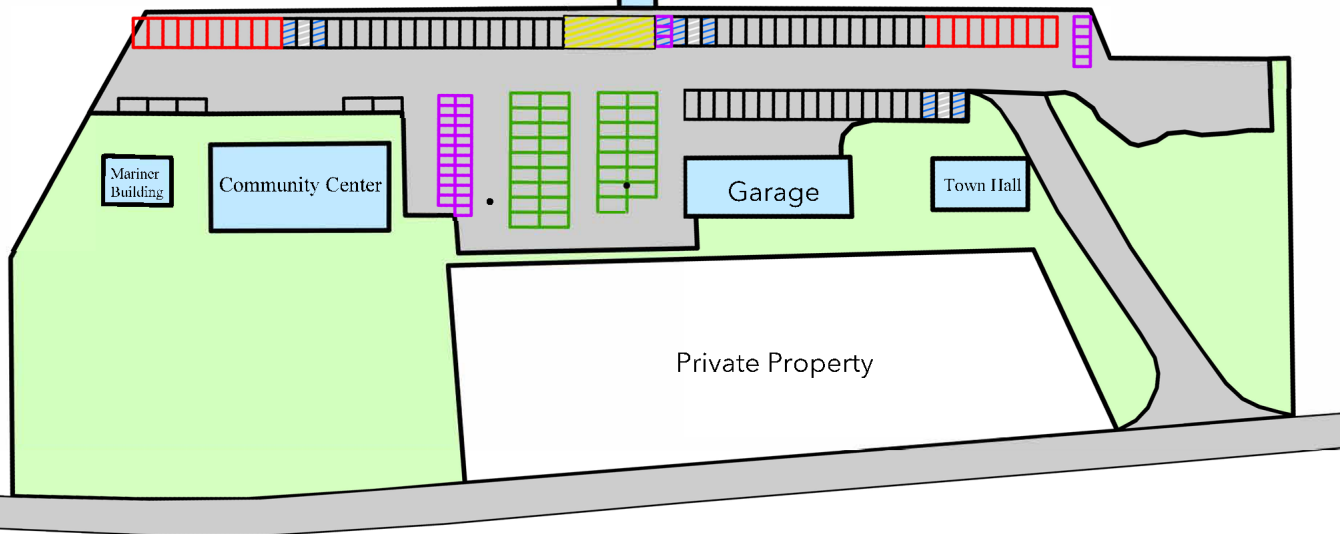

Proposed Parking Lot

Daily - 57 Spots (+12)
Weekly - 37 Spots (+18)
Golf Cart - 36 Spots (+8)
Handicap Cars - 6 Spots
Handicap Carts - 3 Spots

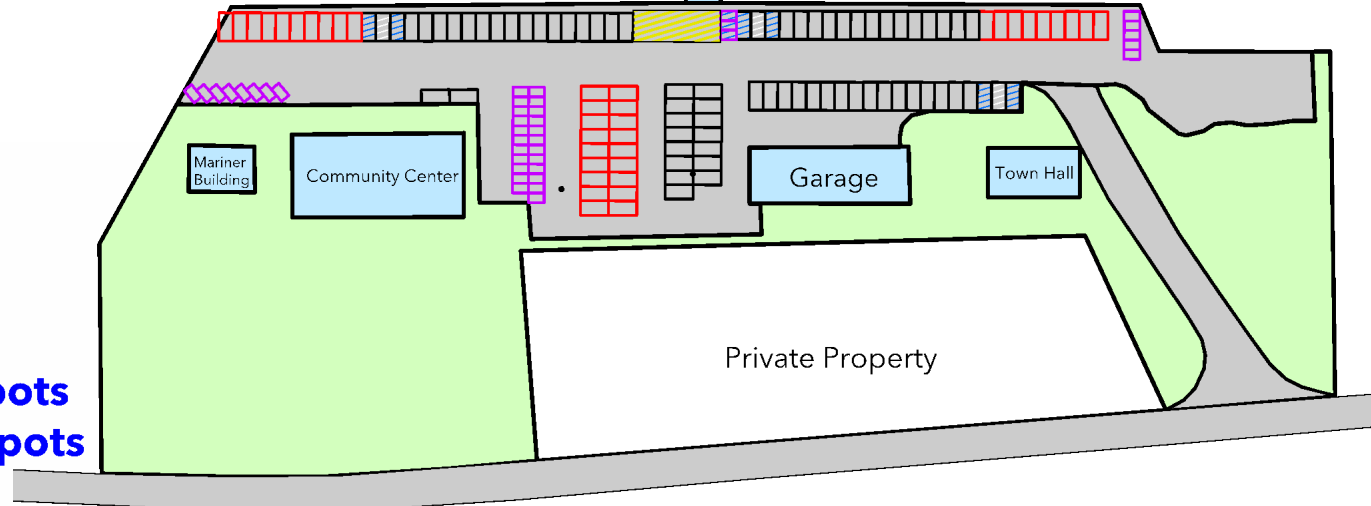

	Current Lot	Proposed Lot
Daily	45	57 (+12)
72 Hour	33	0 (-33)
Weekly	19	37 (+18)
Golf Cart	28	36 (+8)
Total	125	130 (+5)

Improve Enforcement

Mariner's Wharf Parking

- Contractors should park in the so called “east end dirt lot” where the 1-week limit will be enforced. (No more storage)
- We hope that the simplified parking limits will help compliance.
- Identify and remove abandoned vehicles
- Increase parking ticket costs to account for inflation and heightened importance of the violation.
- Enforcement of registrations (i.e., require valid registration prior to ticket payment)

Other Improvements

Mariner's Wharf Parking

- Add golf cart spaces in front of Community Center to help alleviate parking constraints for the over 200 Carts on the island.
- Allow the school bus to pick-up and drop-off in the emergency vehicle parking area (for increased safety).
- Allow surplus street parking on the inland side of Island Avenue during the summer months.



Down Front

Adjust Parking Signage

Down Front Parking

- To alleviate the current congestion, remove parking on waterfront side of Island Avenue between the corner of Garfield Street and Beach Avenue.
- Add a commercial loading and unloading zone in front of the Post Office to be used by Post Office and delivery employees.

Enforce Parking Rules

Down Front Parking

- Enforce current signage regarding the inland side of Island Avenue across from the Condos/Post Office. (2-hour parking)
- Encourage parking on Garfield Street and Beach Avenue to reduce vehicle traffic and congestion near the Bakehouse and Post Office.

Other Improvements

Down Front



The Long Island Comprehensive Plan recommends that we **“Incentivize people to use alternative modes of transportation to decrease the number of cars, including walking, bicycles, and electric golf carts.”** (p. 179)

To incentivize and encourage a walking/cycling downtown:

- Further reduce the 15mph speed limit in the area.
- Add bicycle racks near Bakehouse or Post Office.

Andrews Beach State Park (South Beach)



Improvements

South Beach

- To help encourage no parking on south side of Beach Avenue, move bicycle rack from north side of road to south side.
- To ensure EMS access to the beach, parked vehicles should not obstruct access to the walking path.

Additional Considerations

Long Island Parking Committee

- Community support and participation is imperative for success.
- Be a leader by following all parking rules and only leaving the necessary number of vehicles at the Mariner's parking lot.
- Register all vehicles and promote neighborly ride sharing to reduce congestion (particularly during the busy summer months).
- There was significant public discourse following the 2018 Parking Committee's decisions. We will remain committed to addressing the concerns of the community.

Long Island Parking Committee

Brad Brown

Christian LaMontagne

Jeanie McAleney

Doug McCown

Debra Wallace

Thank You